

# MULTI POSTER STAND

Unit	Piece
------	-------

Dynamic Profile	2
Steel Base and screw set	1
Poster Frame	4
End Cap	1
Connector	2
Dynamic Apparatus	8



## Assembling

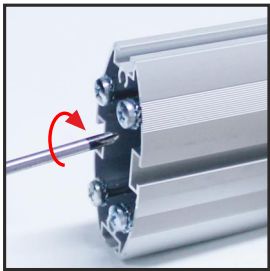

1- Remove the screws on the profiles with using a screwdriver.

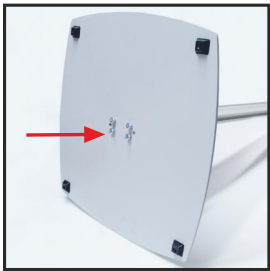

2- Make a position the screws on the base.

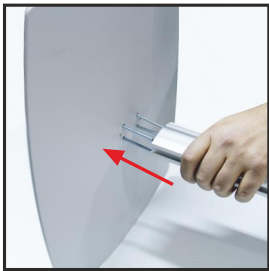

3- Push the screws forward through the profile channel.

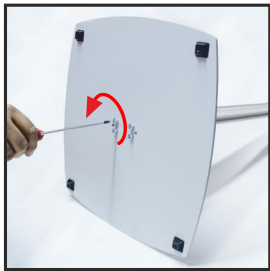

4- Make it stabile by tightening with screwdriver.

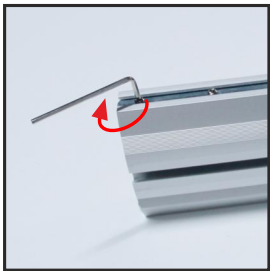

5- Loosen the connection part on the profile with the allen key.

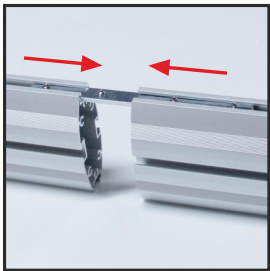

6- Fit the connection profile between the two profiles.



7- Fix the profiles to the connection profile with the allen key.

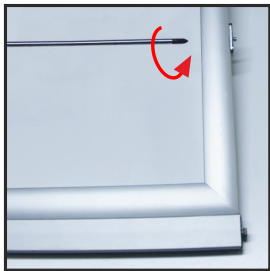

8- Use a screwdriver to loosen the dynamic apparatus on the edge of the sliding frame.

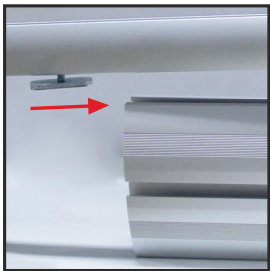

9- Detail.

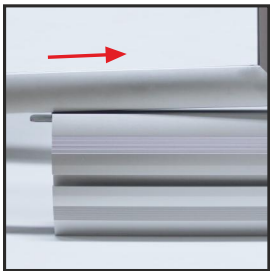

10- Drag the frame's dynamic apparatus to the profile.



11- Tighten the screws to the desired position and tighten.

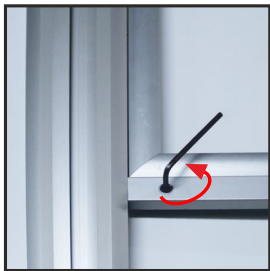

12- Tighten the stabilizing part at the bottom to prevent shaking with the allen key.