

# BUDGET TUBE BANNER STAND INSTRUCTION FOR INSTALLATION

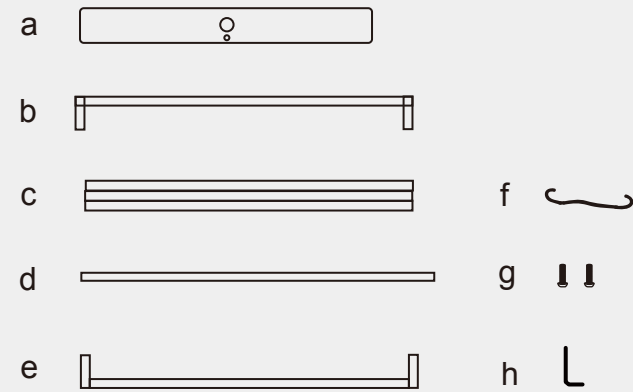

- a. Steel Base (x2)
- b. Top U-shaped tube (x1)
- c. Side vertical tube (x2)
- d. Side vertical slender tube (x1)
- e. Bottom horizontal tube (x1)
- f. Hook with elastic rope (x4)
- g. Bolts (x2)
- h. Rectangular wrench (x1)

## 1 Straighten Side vertical tube "c".

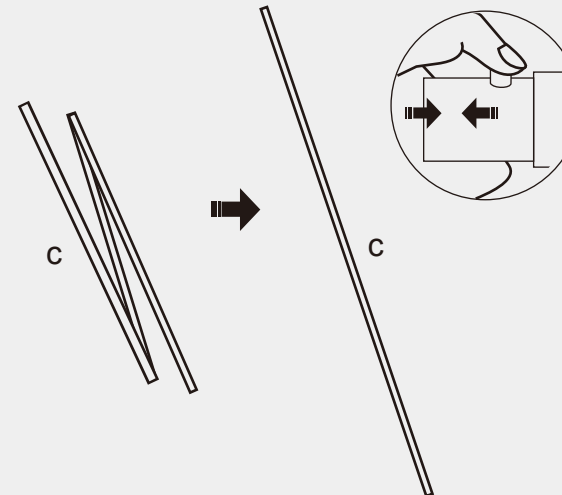

## 2 Assemble the frame as below.

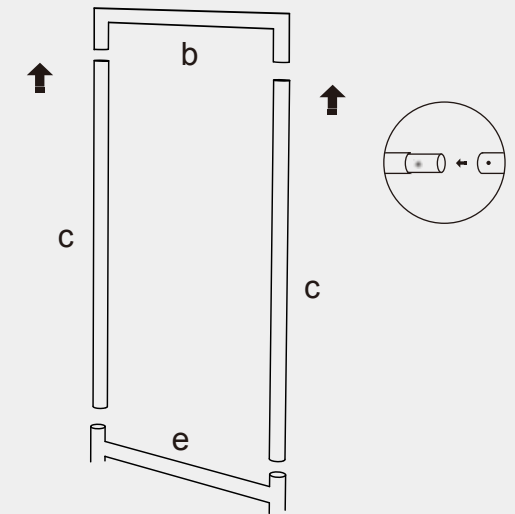

## A PVC Application.

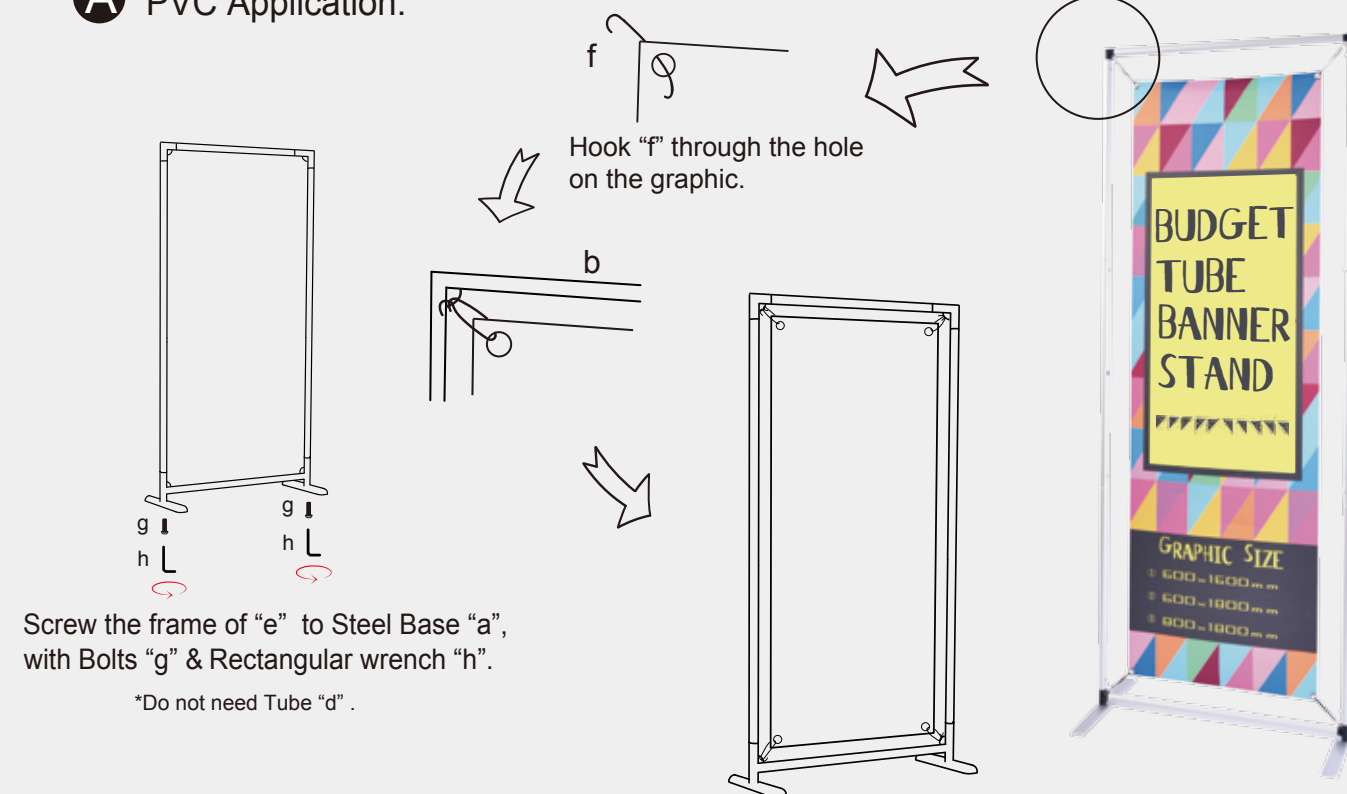

## B Fabric Application.

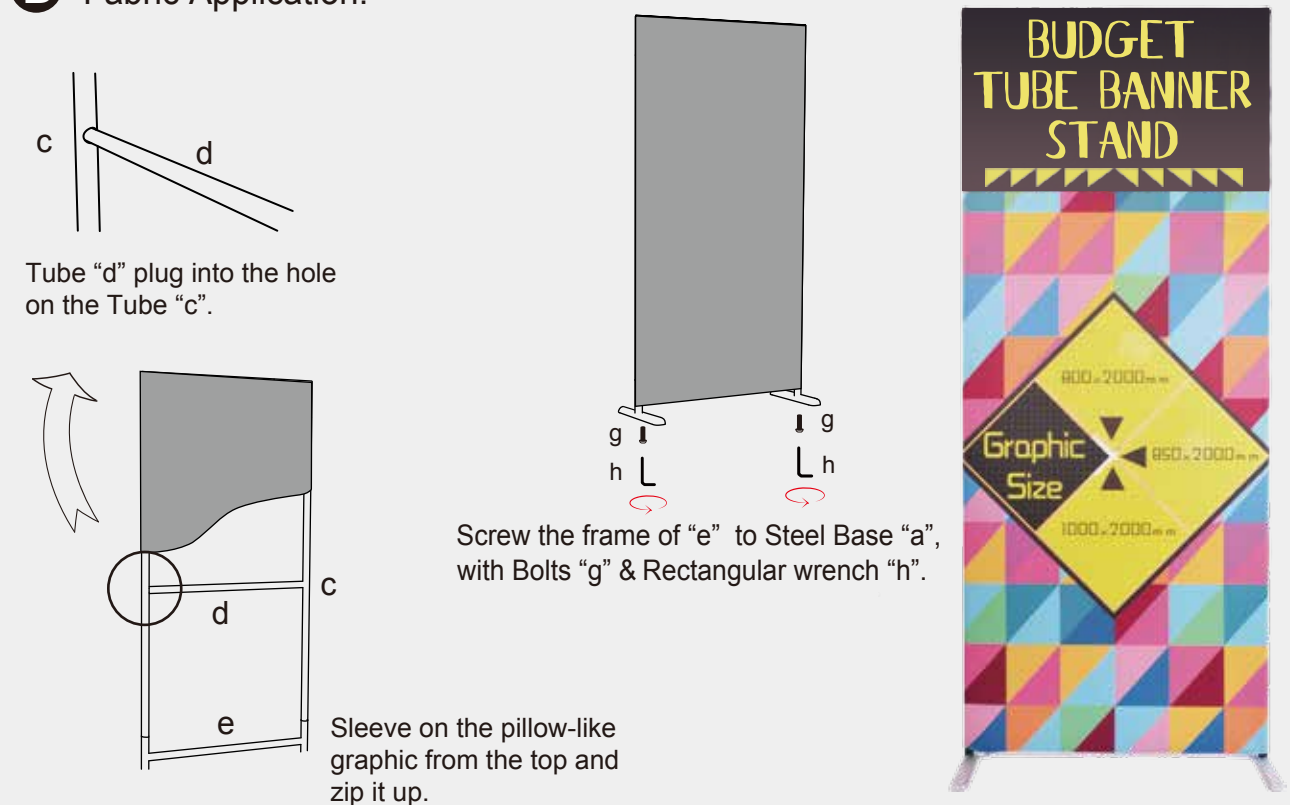

Disassemble in the reverse order.  
Caution : Make sure the graphic is folded neatly and save it in bag after using, to avoid wrinkle.

PLEASE CONTACT US IF THERE IS ANY PROBLEM.